

# ZF-775 直流减速电机 DC GEAR MOTOR Series **SGMADA**®



电压/Main voltage: 3VDC、6VDC、9VDC、12VDC、24VDC

用途/Typical applications: 焊接设备、垃圾处理器、咖啡机、印刷机、稳压机、碎纸机、输卡机、中央空调阀门、办公设备、家用设备、执行器  
Welding machine, Garbage disposers, Coffee machine, Mimeograph, Manostat, Paper shredder, Card conveyors, Central ari-conditioning valve, Office equipment, Household appliances, Automatic actuator.

重量/Weight: 650~700g/pcs(approx)

包装外形尺寸/Packing details: CTN size: 55X35XH18cm 24pcs/CTN G.W.18kgs

## 外形尺寸 APPEARANCE SIZE

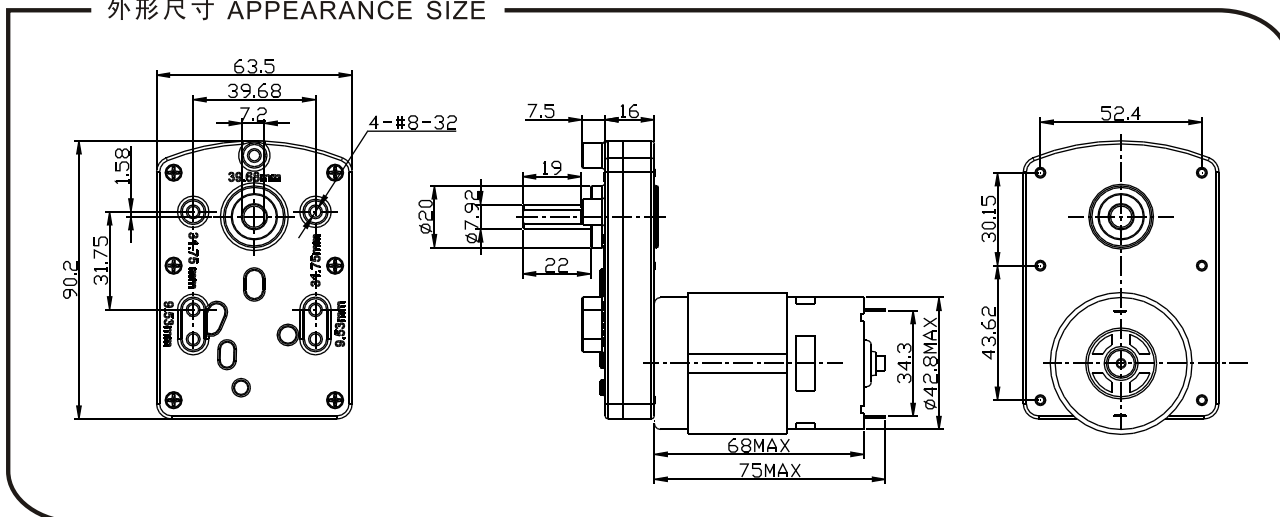

## 齿轮箱数据 Gearbox data

减速箱级数 Number of stages	3 减速比 Stages reduction	4 减速比 Stages reduction	5 减速比 Stages reduction
减速比 Reduction ratio	36、66、 <b>94</b>	129、139、155、196、219、277	232、392、456、555、833
最大运转力矩 Max. Running torque	30kgf.cm	40kgf.cm	50kgf.cm
最大破坏力矩 Max. Gear breking torque	90kgf.cm	120kgf.cm	150kgf.cm
最高齿轮效率 Max. Gearing efficiency	73%	65%	59%

其它减速比请致电或邮件给我司技术部 Other reduction ratio please telephone or e-mail to our engineering department.

## 马达参数 Motor data

马达型号 Motor Model	电压 Rated Volt. V	空载 No load		负载 Load torque				堵转 Stall torque	
		电流 Current	转速 Speed	电流 Current	转速 Speed	扭矩 Torque	输出功率 Output power	扭矩 Torque	电流 Current
		mA	r/min	mA	r/min	gf.cm	W	gf.cm	A
ZF-775123000	12	≤420	3000	≤1300	2430	408	10.4	2484	6.7
ZF-775124500	12	≤750	4500	≤2100	3710	476	17.6	2714	10.4
ZF-775126000	12	≤1300	6000	≤3500	5195	478	25.5	3129	18.6
ZF-775243000	24	≤210	3000	≤600	2590	364	9.87	2050	3.2
ZF-775244500	24	≤480	4500	≤1300	3850	482	18.5	3335	5.3
ZF-775246000	24	≤630	6000	≤2100	5233	574	30.8	4565	12.1

• 马达和齿轮箱装配成减速电机后输出扭矩 = 马达扭矩X减速比X齿轮效率;输出转速 = 马达转速 / 减速比 .

• After connecting motor and gearbox which is named gearmotor the output torque: motor torque X reduction ratio X gearing efficiency; output speed: motor speed/reduction ratio .