

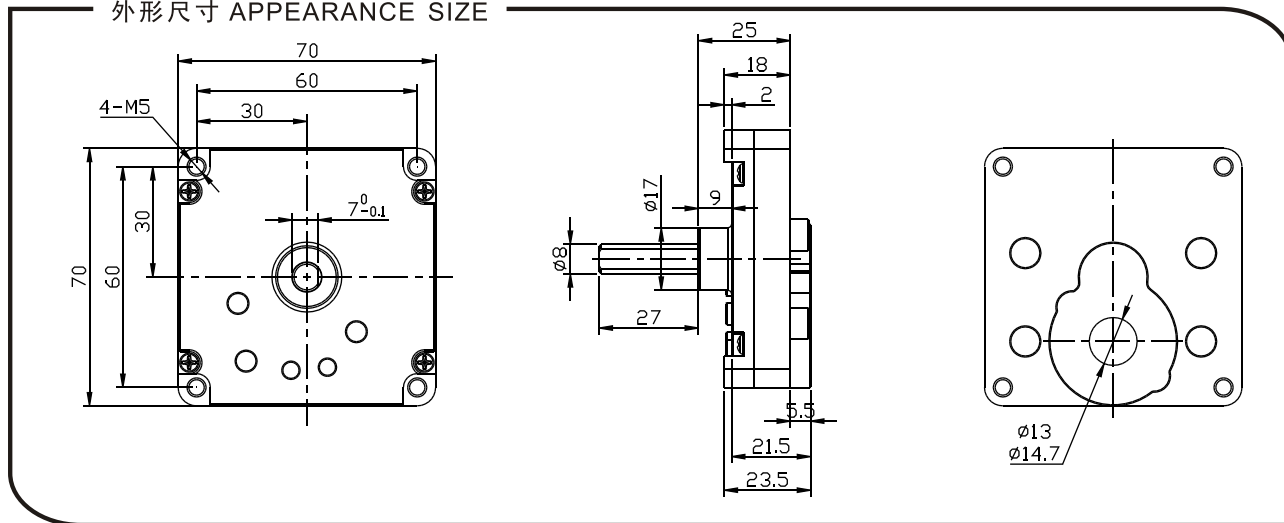

- Note:
- 1、外壳材料：锌合金 Housing material: zinc alloy
  - 2、齿轮间隙，在空载时： $\leq 2^\circ$  Backlash, at no-load:  $\leq 2^\circ$
  - 3、输出轴轴承：滑动轴承 Bearing at output: Sleeve bearings
  - 4、输出轴的径向间隙： $\leq 0.05\text{mm}$  Radial play of shaft:  $\leq 0.05\text{mm}$
  - 5、输出轴轴向间隙： $\leq 0.5\text{mm}$  Thrust play shaft:  $\leq 0.5\text{mm}$
  - 6、齿轮箱可以适用于 555, YJ61 马达。  
The gear box can apply to 555, YJ61 motors.
  - 7、如果电机在低转速、高速比的组合下，负载力矩高于90kgf.cm, 会损坏齿轮箱齿轮。  
When the motors using at low speed, high gear ratio will cause gear motor torque more than 90kgf.cm. At this torque the gears will be broken easily. Be noted.

外形尺寸 APPEARANCE SIZE



说明 PINION SPECIFICATIONS

型号 Model	0.4M		0.5M
牙数 No. of teeth	12	10	13
压力角 Pressure angle	20°		
螺旋角 Helix angle	15° left	—	—
孔径 Hole diameter	φ3.12	φ2.5 (D)	φ2.5 (D)
减速比 Reduction ratio	90, 128, 170, 190, 239, 311, 478, 718	39, 55	13, 17.5, 25

- ★ 电机运行湿度为20%~85% Operating relative humidity 20%~85%RH
- ★ 电机运行温度范围-10℃~+60℃ Operating temperature range -10℃~+60℃

电机安装 MOTOR INSTALLATION

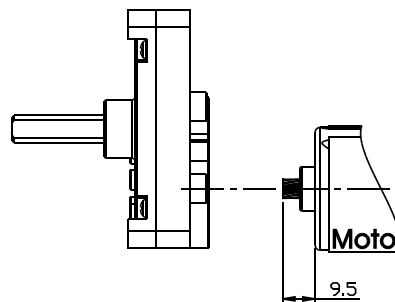

齿轮箱规格 GEARBOXES SPECIFICATIONS

减速比 Reduction ratio	额定扭矩 Rated torque	最大可承受扭矩 Max breaking torque	效率 Efficiency	级数 Number of stages	转向(与电机的转向) Direction (Relationship with motor)
13, 17.5, 25	10kgf. cm	30kgf. cm	73%	3	Different
39, 55	10kgf. cm	30kgf. cm	73%	3	Different
90, 128	30kgf. cm	90kgf. cm	65%	4	Same
170	30kgf. cm	90kgf. cm	65%	4	Same
190	30kgf. cm	90kgf. cm	65%	4	Same
239	30kgf. cm	90kgf. cm	65%	4	Same
331	30kgf. cm	90kgf. cm	59%	5	Different
478	30kgf. cm	90kgf. cm	59%	5	Different
718	30kgf. cm	90kgf. cm	59%	5	Different